

**Chapter E****Ultra-high pressure water jetting hose & fittings****Hose**

<b>2440D</b> – Ultra-high pressure water jetting hose .....	E-4
<b>2440N</b> – Ultra-high pressure water jetting hose .....	E-4

**Related fittings**

<b>1C9LX</b> – Metric female swivel heavy series with O-ring .....	E-5
<b>1AYLX</b> – Type “M” female swivel .....	E-6
<b>1YMLX</b> – High pressure tube nipple metric – LH thread .....	E-7
<b>1YALX</b> – High pressure tube nipple UNF – LH thread .....	E-7
<b>192LX</b> – BSP female swivel (60° cone) .....	E-8
<b>1Y9LX</b> – BSP male for USIT ring .....	E-8
<b>1D9LX</b> – BSP male .....	E-9
<b>1C3LX</b> – Metric female swivel light series .....	E-9
<b>1C6LX</b> – Metric female swivel heavy series .....	E-10
<b>601LX</b> – National Pipe Tapered (NPT) male .....	E-10
<b>6YHLX</b> – UNF male nozzle nipple .....	E-11
<b>6HYLX</b> – Left hand female for water jetting nozzle .....	E-11
<b>66YLX</b> – High pressure female swivel .....	E-12
<b>65YLX</b> – Medium pressure female swivel .....	E-12
<b>6ZELX</b> – Male water jetting nozzle .....	E-13
<b>6Y2LX</b> – Medium pressure tube nipple .....	E-13
<b>606LX</b> – JIC female swivel .....	E-14

**Hose**

<b>2640D</b> – Ultra-high pressure water jetting hose .....	E-14
<b>2640N</b> – Ultra-high pressure water jetting hose .....	E-14

**Related fittings for water jetting applications**

<b>1C9JX</b> – Metric female swivel heavy series with O-ring .....	E-15
<b>1AY2X</b> – Type “M” female swivel .....	E-15
<b>1AYJX</b> – Type “M” female swivel .....	E-15
<b>1YM2X</b> – High pressure tube nipple metric – LH thread .....	E-16
<b>1YMJX</b> – High pressure tube nipple metric – LH thread .....	E-16
<b>1Y42X</b> – High pressure tube nipple UNF – LH thread .....	E-16



**Table of contents**

**16Y2X** – High pressure female swivel..... E-17  
**6Y25X** – Medium pressure tube nipple..... E-17

**Related fittings for hydraulic applications**

**1C95X** – Metric female swivel heavy series with O-ring ..... E-18  
**1AY5X** – Type “M” female swivel ..... E-18  
**1YA5X** – High pressure tube nipple UNF – LH thread ..... E-19  
**1C35X** – Metric female swivel light series..... E-19  
**1925X** – BSP female swivel ..... E-20

**Hose**

**2648N** – Ultra-high pressure water jetting hose ..... E-21

**Related fittings**

**1C9JX** – Metric female swivel heavy series with O-ring ..... E-22  
**1AYJX** – Type “M” female swivel ..... E-22

**Hose**

**2740D** – Ultra-high pressure water jetting hose ..... E-23

**Related fittings**

**1YM2X** – High pressure tube nipple metric – LH thread..... E-24  
**6YMHX**– High pressure tube nipple metric – LH thread..... E-24  
**1Y42X** – High pressure tube nipple UNF – LH thread ..... E-24  
**6Y4HX** – High pressure tube nipple UNF – LH thread ..... E-24  
**1AY2X** – Type “M” female swivel ..... E-25  
**16Y2X** – High pressure female swivel..... E-25  
**692HX** – BSP female swivel ..... E-26

**Hose**

**2741D** – Ultra-high pressure water jetting hose ..... E-27

**Related fittings**

**1YMDX**– High pressure tube nipple metric – LH thread..... E-28  
**1YADX** – High pressure tube nipple UNF – LH thread ..... E-28  
**1AY2X** – Type “M” female swivel ..... E-29



**Hose**

**2748D** – Ultra-high pressure water jetting hose ..... E-30

**Related fittings**

**1YM2X** – High pressure tube nipple metric – LH thread..... E-31

**1Y42X** – High pressure tube nipple UNF – LH thread ..... E-31

**1AY2X** – Type “M” female swivel ..... E-32



## 2440D / 2440N – Ultra-high pressure water jetting hose



### APPLICATIONS

- Ultra-high pressure service for the construction and shipbuilding industries and for general industrial cleaning applications.
- Mainly used for hydrodemolition and removal of accumulated dirt and materials from surfaces such as concrete, asphalt and tanks.
- For use with petroleum or synthetic hydraulic fluids, gas and chemical fluids. Especially suitable for hydraulic pre-tensioning equipment, test rigs, as well as in offshore oil applications.

### CONSTRUCTION

**Core tube** : DN 4-8: Polyoxymethylene; DN 10-25: Polyamide  
**Pressure reinforcement** : Four spiral layers of maximum tensile steel wire

**Cover** : Polyamide  
**Colour** : DN 4-8: blue; DN 10-25: black

### TEMPERATURE RANGE

-10°C up to +70°C

#	Ø				Ø		↻		✂		↷	⊞
	DN	size	mm	inch	mm	MPa	psi	MPa	psi	mm	kg/m	
2440D-025V32	4	-025	3.9	5/32	10.4	220	31,900	550	79,750	100	0.21	
2440D-03V32	5	-03	4.7	3/16	11.5	180	26,100	450	65,250	130	0.28	
2440D-04V32	6	-04	6.3	1/4	12.5	164	23,780	410	59,450	155	0.33	
2440D-05V32	8	-05	8.0	5/16	15.1	150	21,750	375	54,375	175	0.44	
2440N-06V30	10	-06	9.7	3/8	19.4	140	20,300	350	50,750	190	0.70	
2440N-08V30	12	-08	12.8	1/2	22.5	130	18,850	325	47,125	200	0.94	
2440N-12V30	20	-12	19.6	3/4	30.0	100	14,500	250	36,250	250	1.39	
2440N-16V30	25	-16	25.0	1	37.0	90	13,050	225	32,625	300	1.90	

NOTES -



## 1C9LX – Metric female swivel heavy series with O-ring

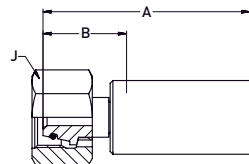

**MATERIAL** High strength carbon steel, zinc plated

#	⊙				📏	A	B	J	↗	
	DN	size	mm	inch					MPa	psi
1C9LX-16-04	6	-04	6.4	1/4	M24x1.5	70	39	30	164	23,780
1C9LX-14-06	10	-06	9.5	3/8	M22x1.5	75	30	30	140	20,300
1C9LX-16-08	12	-08	12.7	1/2	M24x1.5	88	34	32	130	18,850
1C9LX-25-12	20	-12	19.0	3/4	M36x2	92	39	46	100	14,500
1C9LX-30-16	25	-16	25.4	1	M42x2	98	45	50	90	13,050

Ultra-high pressure

## 1C9LX – Metric female swivel heavy series with O-ring

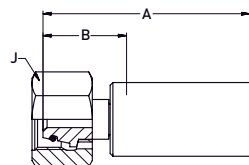

**MATERIAL** Stainless steel

#	⊙				📏	A	B	J	↗	
	DN	size	mm	inch					MPa	psi
1C9LX-16-05C	8	-05	7.9	5/16	M24x1.5	76	37	30	150	21,750
1C9LX-14-06C	10	-06	9.5	3/8	M22x1.5	76	30	30	140	20,300
1C9LX-16-08C	12	-08	12.7	1/2	M24x1.5	87	34	32	130	18,850
1C9LX-25-12C	20	-12	19.0	3/4	M36x2	92	39	46	100	14,500
6C9LX-30-16C	25	-16	25.4	1	M42x2	118	52	50	90	13,050



## 1AYLX – Type “M” female swivel

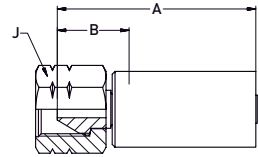

**MATERIAL** High strength carbon steel, zinc plated

#	⊙				⌚	A	B	J	⌚	
	DN	size	mm	inch					MPa	psi
1AYLX-6-03	5	-03	4.8	3/16	9/16 - 18UNF	66	26	22	180	26,100
1AYLX-6-04	6	-04	6.4	1/4	9/16 - 18UNF	61	29	22	164	23,780
1AYLX-8-05	8	-05	7.9	5/16	3/4 - 16UNF	74	30	27	150	21,750
1AYLX-8-06	10	-06	9.5	3/8	3/4 - 16UNF	70	26	27	140	20,300
1AYLX-11-08	12	-08	12.7	1/2	1 - 12UNF	80	27	32	130	18,850
1AYLX-16-12	20	-12	19.0	3/4	1 5/16-12UNF	82	29	41	100	14,500

## 1AYLX – Type “M” female swivel

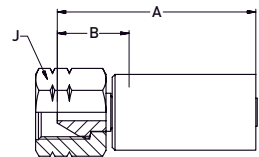

**MATERIAL** Stainless steel

#	⊙				⌚	A	B	J	⌚	
	DN	size	mm	inch					MPa	psi
6AYLX-6-2AC	3	-02	3.2	1/8	9/16 - 18 UNF	64	33	17	220	31,900
1AYLX-6-03C	5	-03	4.8	3/16	9/16 - 18 UNF	67	26	22	180	26,100
1AYLX-8-05C	8	-05	7.9	5/16	3/4 - 16 UNF	70	31	27	150	21,750
1AYLX-8-06C	10	-06	9.5	3/8	3/4 - 16 UNF	70	25	27	140	20,300
1AYLX-11-08C	12	-08	12.7	1/2	1 - 12 UNF	81	27	32	130	18,850
1AYLX-16-12C	20	-12	19.0	3/4	1 5/16-12 UNF	82	29	41	100	14,500
6AYLX-16-16C	25	-16	25.4	1	1 5/16 - 12 UNF	139	52	38	90	13,050

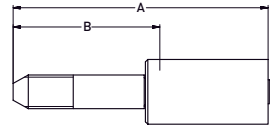

**1YMLX – High pressure tube nipple  
metric – LH thread****MATERIAL** High strength carbon steel, zinc plated

#	⊙				🌀	A	B	↗	
	DN	size	mm	inch				MPa	psi
1YMLX-6-05	8	-05	7.9	5/16	M14x1.5-LH	110	66	150	21,750
1YMLX-11-08	12	-08	12.7	1/2	M18x1.5-LH	120	65	130	18,850

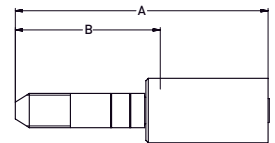
**1YALX – High pressure tube nipple  
UNF – LH thread****MATERIAL** Special materials

#	⊙				🌀	A	B	↗	
	DN	size	mm	inch				MPa	psi
1YALX-1-025	4	-025	4.0	5/32	1/4 - 28UNF-LH	87	50	220	31,900
1YALX-3-025	4	-025	4.0	5/32	3/8 - 24UNF-LH	89	50	220	31,900
1YALX-1-03	5	-03	4.8	3/16	1/4 - 28UNF-LH	92	53	180	26,100
1YALX-3-03	5	-03	4.8	3/16	3/8 - 24UNF-LH	99	57	180	26,100
1YALX-6-03	5	-03	4.8	3/16	9/16 - 18UNF-LH	108	78	180	26,100
1YALX-3-04	6	-04	6.4	1/4	3/8 - 24UNF-LH	102	58	164	23,780
1YALX-6-04	6	-04	6.4	1/4	9/16 - 18UNF-LH	112	67	164	23,780
1YALX-6-05	8	-05	7.9	5/16	9/16 - 18UNF-LH	110	66	150	21,750



## 192LX – BSP female swivel (60° cone)

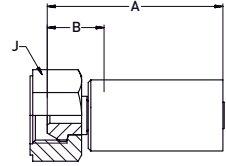

**MATERIAL** High strength carbon steel, zinc plated

#	⊙				⌚	A	B	J	↗	
	DN	size	mm	inch					MPa	psi
192LX-4-03	5	-03	4.8	3/16	G 1/4	64	25	22	180	26,100
192LX-6-05	8	-05	7.9	5/16	G 3/8	69	25	27	150	21,750
192LX-8-06	10	-06	9.5	3/8	G 1/2	66	22	30	140	20,300
192LX-8-08	12	-08	12.7	1/2	G 1/2	75	21	32	130	18,850
192LX-16-12	20	-12	19.0	3/4	G 1	77	24	41	100	14,500
192LX-20-16	25	-16	25.4	1	G 1 1/4	78	25	50	90	13,050

## 1Y9LX – BSP male for USIT ring

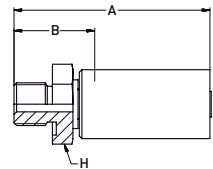

**MATERIAL** High strength carbon steel, zinc plated

#	⊙				⌚	A	B	H	↗	
	DN	size	mm	inch					MPa	psi
1Y9LX-4-03	5	-03	4.8	3/16	G 1/4	72	32	22	180	26,100
1Y9LX-8-08	12	-08	12.7	1/2	G 1/2	87	32	36	130	18,850



## 1D9LX – BSP male

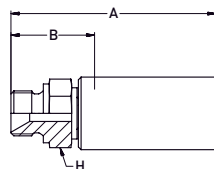

**MATERIAL** High strength carbon steel, zinc plated

#	⊙				⌚	A	B	H	↗	
	DN	size	mm	inch					MPa	psi
1D9LX-4-03	5	-03	4.8	3/16	G 1/4	77	35	19	180	26,100
1D9LX-4-04	6	-04	6.4	1/4	G 1/4	80	36	19	164	23,780

Ultra-high pressure

## 1C3LX – Metric female swivel light series

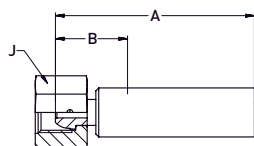

**MATERIAL** High strength carbon steel, zinc plated

#	⊙				⌚	A	B	J	↗	
	DN	size	mm	inch					MPa	psi
1C3LX-8-03	5	-03	4.8	3/16	M14x1.5	64	25	22		
1C3LX-8-04	6	-04	6.4	1/4	M14x1.5	69	25	22		



## 1C6LX – Metric female swivel heavy series

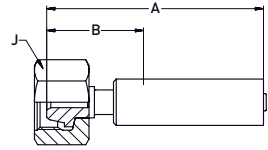

**MATERIAL** High strength carbon steel, zinc plated

#	⊙				⋈	A	B	J	↻	
	DN	size	mm	inch					MPa	psi
1C6LX-12-05	8	-05	7.9	5/16	M20x1.5	78	34	27		

## 601LX – National Pipe Tapered (NPT) male

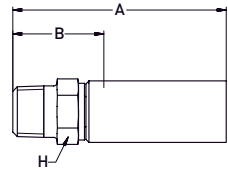

**MATERIAL** Special materials

**NOTE** \*ProLance fitting

#	⊙				⋈	A	B	R	↻	
	DN	size	mm	inch					MPa	psi
601LX-2-2AC*	3	-02	3.2	1/8	1/8 NPT ProLance	48	19	13	103.4	15,000
601LX-4-3	5	-03	4.8	3/16	1/4 NPT	73	33	14	103.4	15,000
601LX-2-4	6	-04	6.4	1/4	1/8 NPT	64	30	16	103.4	15,000
601LX-4-4	6	-04	6.4	1/4	1/4 NPT	66	33	16	103.4	15,000
601LX-4-4C	6	-04	6.4	1/4	1/4 NPT	67	34	16	103.4	15,000
601LX-4-5	8	-05	7.9	5/16	1/4 NPT	71	30	16	103.4	15,000
601LX-4-5C	8	-05	7.9	5/16	1/4 NPT	71	30	16	103.4	15,000
601LX-6-5	8	-05	7.9	5/16	3/8 NPT	75	35	19	103.4	15,000
601LX-6-5C	8	-05	7.9	5/16	3/8 NPT	75	35	19	103.4	15,000
601LX-8-8	12	-08	12.7	1/2	1/2 NPT	95	43	29	103.4	15,000
601LX-8-8C	12	-08	12.7	1/2	1/2 NPT	95	43	29	103.4	15,000
601LX-12-12C	20	-12	19.0	3/4	3/4 NPT	121	53	35	69.0	10,000
601LX-16-12C	20	-12	19.0	3/4	1 NPT	124	57	35	69.0	10,000
601LX-16-16C	25	-16	25.4	1	1 NPT	125	64	35	69.0	10,000

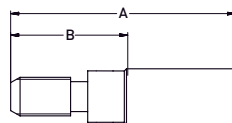

## 6YHLX – UNF male nozzle nipple

**MATERIAL** Special materials**NOTE** \*ProLance fitting

#	⊙				⌚	A	B	↗	
	DN	size	mm	inch				MPa	psi
6YHLX-4-2AC-LH	3	-02	3.2	1/8	1/4 - 28 UNF LH	53	22	220.0	31,900
6YHLX-4-3C-LH	5	-03	4.8	3/16	1/4 - 28 UNF LH	69	39	180.0	26,100
6YHLX-6-3C	5	-03	4.8	3/16	3/8 - 24 UNF	66	36	180.0	26,100
6YHLX-6-3C-LH	5	-03	4.8	3/16	3/8 - 24 UNF LH	66	36	180.0	26,100
6YHLX-6-4C	6	-04	6.4	1/4	3/8 - 24 UNF	66	36	137.9	20,000
6YHLX-6-4C-LH	6	-04	6.4	1/4	3/8 - 24 UNF LH	66	36	137.9	20,000

Ultra-high pressure

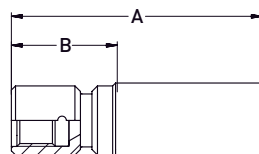
6HYLX – Left hand female  
for water jetting nozzle**MATERIAL** Special materials**NOTE** \*ProLance fitting

#	⊙				⌚	A	B	↗	
	DN	size	mm	inch				MPa	psi
6HYLX-4-2AC	3	-02	3.2	1/8	1/4 - 28 UNF	49	21	220.0	31,900
6HYLX-6-3C	5	-03	4.8	3/16	3/8 - 24 UNF	50	18	180.0	26,100
6HYLX-6-4C	6	-04	6.4	1/4	3/8 - 24 UNF	46	15	137.9	20,000
6HYLX-9-5C-LH	8	-05	7.9	5/16	9/16 - 18 UNF LH	66	22	137.9	20,000



## 66YLX – High pressure female swivel

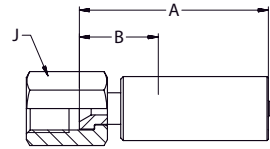

**MATERIAL** Special materials

#	⊙				⋈	A	B	H	⌚	
	DN	size	mm	inch					MPa	psi
66YLX-4-3	5	-03	4.8	3/16	9/16 - 18 UNF	71	33	19	180	26,100
66YLX-4-3C	5	-03	4.8	3/16	9/16 - 18 UNF	74	36	17	180	26,100

## 65YLX – Medium pressure female swivel

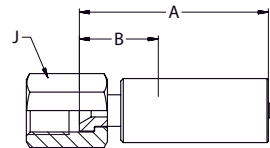

**MATERIAL** Special materials

#	⊙				⋈	A	B	J	⌚	
	DN	size	mm	inch					MPa	psi
65YLX-6-3	5	-03	4.8	3/16	9/16 - 18	78	39	19	137.9	20,000
65YLX-6-4	6	-04	6.4	1/4	9/16 - 18	72	39	19	137.9	20,000
65YLX-6-4C	6	-04	6.4	1/4	9/16 - 18	72	39	19	137.9	20,000

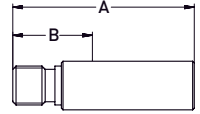

**6ZELX – Male water jetting nozzle****MATERIAL** Special materials**NOTE** \*ProLance fitting

#						A	B		
	DN	size	mm	inch	inch	mm	mm	MPa	psi
6ZELX-5-3C	5	-03	4.8	3/16	5/16 - 24 RH	56	28	137.9	20,000

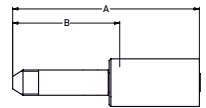
**6Y2LX – Medium pressure tube nipple****MATERIAL** Special materials

#						A	B		
	DN	size	mm	inch		mm	mm	MPa	psi
6Y2LX-9-5C	8	-05	7.9	5/16	9/16 - 18 LH	97	54	137.9	20,000
6Y2LX-12-5C	8	-05	7.9	5/16	3/4 - 16 LH	95	52	137.9	20,000
6Y2LX-9-6C	10	-06	9.5	3/8	9/16 - 18 LH	97	52	137.9	20,000
6Y2LX-9-8C	12	-08	12.7	1/2	9/16 - 18 LH	107	56	137.9	20,000
6Y2LX-12-8C	10	-06	9.5	3/8	3/4 - 16 LH	105	53	137.9	20,000
6Y2LX-16-12C	20	-12	19.0	3/4	1 - 14 LH	137	70	103.4	15,000



## 2640D / 2640N – Ultra-high pressure water jetting hose



### APPLICATIONS

- Ultra-high pressure service for the construction and shipbuilding industries and for general industrial cleaning applications.
- Mainly used for hydrodemolition and removal of accumulated dirt and materials from surfaces such as concrete, asphalt and tanks.
- For use with petroleum or synthetic hydraulic fluids, gas and chemical fluids. Especially suitable for hydraulic pre-tensioning equipment, test rigs, as well as in offshore oil applications.

### CONSTRUCTION

**Core tube** : DN 4-8: Polyoxymethylene; DN 12-25: Polyamide  
**Pressure reinforcement** : Six spiral layers of maximum tensile steel wire

**Cover** : Polyamide  
**Colour** : Blue

### TEMPERATURE RANGE

-10°C up to +70°C

#	Ø				Ø		↗		✂		↶		I
	DN	size	mm	inch	mm	MPa	psi	MPa	psi	mm	kg/m		
2640D-025V32	4	-025	3.9	5/32	12.0	280	40,600	700	101,500	140	0.29		
2640D-03V32	5	-03	4.7	3/16	13.0	250	36,250	625	90,625	175	0.41		
2640D-05V32	8	-05	8.0	5/16	16.9	210	30,450	525	76,125	225	0.68		
2640N-08V32	12	-08	12.8	1/2	24.5	180	26,100	450	65,250	290	1.36		
2640N-12V32	20	-12	19.6	3/4	33.0	140	20,300	350	50,750	350	2.10		
2640N-16V32	25	-16	25.0	1	40.0	120	17,400	300	43,500	400	2.90		

NOTES -

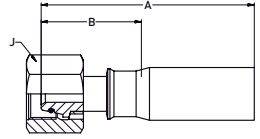

**1C9JX – Metric female swivel heavy series  
with O-ring**

**MATERIAL** Nipple: very high strength stainless steel  
Shell and nut: high strength carbon steel, zinc plated

#	⊙				📏	A	B	J	↻	
	DN	size	mm	inch					MPa	psi
1C9JX-16-08W	12	-08	12.7	1/2	M24x1.5	96	39	32	180	26,100
1C9JX-25-12W	20	-12	19.0	3/4	M36x2	108	49	46	140	20,300
1C9JX-30-16W	25	-16	25.4	1	M42x2	121	55	55	120	17,400

**Fittings for water jetting applications**

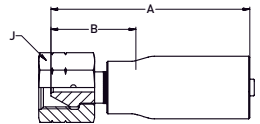
**1AY2X / 1AYJX – Type “M” female swivel**

**MATERIAL** Nipple: very high strength stainless steel  
Shell and nut: high strength carbon steel, zinc plated

#	⊙				📏	A	B	J	↻	
	DN	size	mm	inch					MPa	psi
1AY2X-6-025	4	-025	4.0	5/32	9/16 - 18UNF	61	24	22	300	43,500
1AY2X-6-03	5	-03	4.8	3/16	9/16 - 18UNF	91	38	22	400	58,000
1AY2X-8-05	8	-05	7.9	5/16	3/4 - 16UNF	91	38	27	320	46,400
1AY2X-10-05	8	-05	7.9	5/16	7/8 - 14UNF	91	38	30	320	46,400
1AY2X-13-05	8	-05	7.9	5/16	1 1/8 - 11UNF	91	38	36	320	46,400
1AYJX-11-08W	12	-08	12.7	1/2	1 - 12UNF	86	29	32	180	26,100
1AYJX-16-12W	20	-12	19.0	3/4	1 5/16-12UNF	90	31	41	140	20,300

**Fittings for water jetting applications**



## 1YM2X / 1YMJX – High pressure tube nipple metric – LH thread

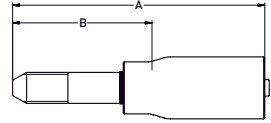

**MATERIAL** Nipple: very high strength stainless steel  
 Shell: high strength carbon steel, zinc plated

#						A	B		
	DN	size	mm	inch				mm	mm
1YM2X-6-03	5	-03	4.8	3/16	M14x1.5-LH	116	63	400	58,000
1YM2X-6-05	8	-05	7.9	5/16	M14x1.5-LH	116	63	320	46,400
1YMJX-11-08W	12	-08	12.7	1/2	M18x1.5-LH	141	87	180	26,100
1YMJX-12-08W	12	-08	12.7	1/2	M20x1.5-LH	141	87	180	26,100

**Fittings for water jetting applications**

## 1Y42X – High pressure tube nipple UNF – LH thread

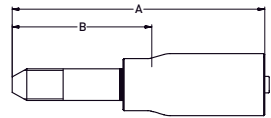

**MATERIAL** Nipple: very high strength stainless steel  
 Shell and nut: high strength carbon steel, zinc plated

#						A	B		
	DN	size	mm	inch				mm	mm
1Y42X-4-025	4	-025	4.0	5/32	1/4 - 28UNF-LH	87	50	300	43,500
1Y42X-6-025	4	-025	4.0	5/32	3/8 - 24UNF-LH	92	55	300	43,500
1Y42X-6-03	5	-03	4.8	3/16	3/8 - 24UNF-LH	108	58	400	58,000
1Y42X-9-03	5	-03	4.8	3/16	9/16 - 18UNF-LH	116	63	400	58,000
1Y42X-6-05	8	-05	7.9	5/16	3/8 - 24UNF-LH	116	63	320	46,400
1Y42X-9-05	8	-05	7.9	5/16	9/16 - 18UNF-LH	116	63	320	46,400

**Fittings for water jetting applications**



## 16Y2X – High pressure female swivel

**MATERIAL** Nipple: very high strength stainless steel  
Shell and nut: high strength carbon steel, zinc plated

#	⊙					A	B	J	↗	
	DN	size	mm	inch					MPa	psi
16Y2X-4-025	4	-25	4	5/32	9/16 - 18	76	23	19	300	43,500
16Y2X-4-03	5	-03	4.8	3/16	9/16 - 18	76	23	19	280	40,600

**Fittings for water jetting applications**

Ultra-high pressure

## 6Y25X – Medium pressure tube nipple

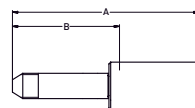

**MATERIAL** Nipple: very high strength stainless steel  
Shell: stainless steel

#	⊙					A	B	↗	
	DN	size	mm	inch				MPa	psi
6Y25X-9-8C	12	-08	12.7	1/2	9/16 - 18 LH	109	56	137.9	20,000
6Y25X-12-8C	10	-06	9.5	3/8	3/4 - 16 LH	107	53	137.9	20,000
6Y25X-16-12C	20	-12	19.0	3/4	1 - 14 LH	139	70	137.9	20,000

**Fittings for water jetting applications**



## 1C95X – Metric female swivel heavy series with O-ring

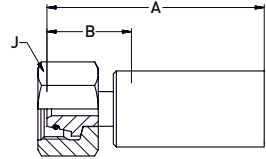

**MATERIAL** Nipple: very high strength carbon steel, zinc plated  
 Shell and nut: high strength carbon steel, zinc plated

#	⊙				🌀	A	B	J	⌚	
	DN	size	mm	inch					MPa	psi
1C95X-12-05	8	-05	7.9	5/16	M20x1.5	72	28	27	210	30,450
1C95X-16-08	12	-08	12.7	1/2	M24x1.5	87	34	32	180	26,100
1C95X-25-12	20	-12	19	3/4	M36x2	92	39	46	140	20,300

**Fittings for hydraulic applications**

## 1A5X – Type “M” female swivel

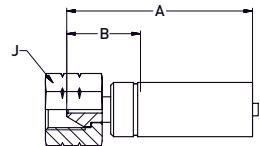

**MATERIAL** Nipple: very high strength carbon steel, zinc plated  
 Shell and nut: high strength carbon steel, zinc plated

#	⊙				🌀	A	B	J	⌚	
	DN	size	mm	inch					MPa	psi
1A5X-6-03	5	-03	4.8	3/16	9/16 - 18UNF	66	26	22	250	36,250
1A5X-8-05	8	-05	7.9	5/16	3/4 - 16UNF	69	25	27	210	30,450
1A5X-11-08	12	-08	12.7	1/2	1 - 12UNF	80	27	32	180	26,100
1A5X-16-12	20	-12	19	3/4	1 5/16 - 12UNF	82	29	41	140	20,300

**Fittings for hydraulic applications**

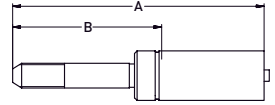

**1YA5X – High pressure tube nipple  
UNF – LH thread****MATERIAL** Special materials

#	⊙				⌚	A	B	↗	
	DN	size	mm	inch				MPa	psi
1YA5X-1-03	5	-03	4.8	3/16	1/4 - 28UNF-LH	92	53	250	36,250
1YA5X-3-03	5	-03	4.8	3/16	3/8 - 24UNF-LH	97	58	250	36,250
1YA5X-6-05	8	-05	7.9	5/16	9/16 - 18UNF-LH	104	60	210	30,450

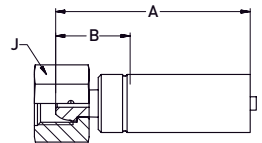
**Fittings for hydraulic applications****1C35X – Metric female swivel light series****MATERIAL** Nipple: very high strength carbon steel, zinc plated  
Shell and nut: high strength carbon steel, zinc plated



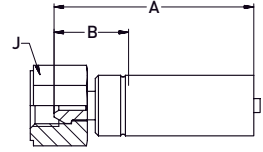

#	⊙				⌚	A	B	J	↗	
	DN	size	mm	inch					MPa	psi
1C35X-8-03	5	-03	4.8	3/16	M14x1.5	64	25	22	250	36,250

**Fittings for hydraulic applications**

## 1925X – BSP female swivel



**MATERIAL** Nipple: very high strength carbon steel, zinc plated  
 Shell and nut: high strength carbon steel, zinc plated

#						A	B			
	DN	size	mm	inch		mm	mm	mm	MPa	psi
1925X-4-3	5	-03	4.8	3/16	G 1/4	78	32	22	250	36,250

**Fittings for hydraulic applications**



## 2648N – Ultra-high pressure water jetting hose



### APPLICATIONS

- Ultra-high pressure service for the construction and shipbuilding industries and for general industrial cleaning applications.
- Mainly used for hydrodemolition and removal of accumulated dirt and materials from surfaces such as concrete, asphalt and tanks.







### CONSTRUCTION

**Core tube** : Polyamide  
**Pressure reinforcement** : Six spiral layers of maximum tensile steel wire

**Cover** : Polyamide  
**Colour** : Blue

### TEMPERATURE RANGE

-10°C up to +70°C

#												
	DN	size	mm	inch	mm	MPa	psi	MPa	psi	mm	kg/m	
2648N-12V32	20	-12	19.6	3/4	33.0	160	23,200	400	58,000	350	2.28	
2648N-16V32	25	-16	25.0	1	40.8	150	21,750	375	54,375	400	3.10	

NOTES -



## 1C9JX / 1C9CX – Metric female swivel heavy series with O-ring

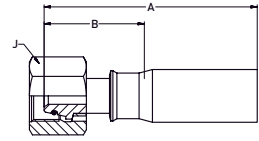

**MATERIAL** Nipple: very high strength stainless steel  
 Shell and nut: high strength carbon steel, zinc plated

#	⊙				⋈	A	B	J	⊙	
	DN	size	mm	inch					MPa	psi
<b>1C9JX-25-12W</b>	20	-12	19.0	3/4	M36x2	108	50	46	160	23,200
<b>1C9CX-30-16W</b>	25	-16	25.4	1	M42x2	121	55	55	150	21,750

## 1AYJX – Type “M” female swivel

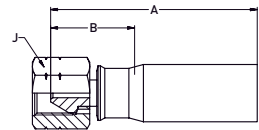

**MATERIAL** Nipple: very high strength stainless steel  
 Shell and nut: high strength carbon steel, zinc plated

#	⊙				⋈	A	B	J	⊙	
	DN	size	mm	inch					MPa	psi
<b>1AYJX-16-12W</b>	20	-12	19.0	3/4	1 5/16-12UNF	90	31	41	160	23,200



Ultra-high pressure

## 2740D – Ultra-high pressure water jetting hose



### APPLICATIONS







- For very-high pressure lances with working pressures up to 300 MPa for the construction and shipbuilding industries or for common industrial cleaning applications.
- Mainly used for hydrodemolition and removal of accumulated dirt and materials from surfaces such as concrete, asphalt and tanks.

### CONSTRUCTION

**Core tube** : Polyoxymethylene  
**Pressure reinforcement** : Six spiral layers of maximum tensile steel wire  
  
**Cover** : Polyamide  
**Colour** : Yellow, red

### TEMPERATURE RANGE

-10°C up to +70°C

#													
	DN	size	mm	inch	mm	MPa	psi	MPa	psi	mm	kg/m		
2740D-025V16	4	-025	4.0	5/32	12.0	300	43,500	780	113,100	120	0.40		
2740D-03V34	5	-03	4.7	3/16	13.2	280	40,600	700	101,500	200	0.47		
2740D-05V34	8	-05	7.7	5/16	17.2	250	36,250	625	90,625	200	0.70		
2740D-08V30	12	-08	12.7	1/2	27.0	200	29,000	500	72,500	300	1.85		

NOTES -



## 1YM2X / 6YMHX – High pressure tube nipple metric – LH thread

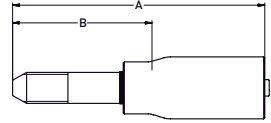

**MATERIAL** Nipple: very high strength stainless steel  
 Shell and nut: high strength carbon steel, zinc plated

#	⊙				⋯	A	B	⊙ ↗	
	DN	size	mm	inch				MPa	psi
1YM2X-6-03	5	-03	4.8	3/16	M14x1.5-LH	116	63	400	58,000
1YM2X-6-05	8	-05	7.9	5/16	M14x1.5-LH	116	63	320	46,400
6YMHX-11-8C	12	-08	12.8	1/2	M18x1.5-LH	189	125	200	29,000
6YMHX-12-8C	12	-08	12.8	1/2	M20x1.5-LH	189	125	200	29,000

## 1Y42X / 6Y4HX – High pressure tube nipple UNF – LH thread

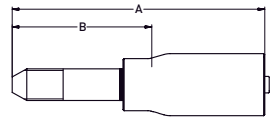

**MATERIAL** Nipple: very high strength stainless steel  
 Shell and nut: high strength carbon steel, zinc plated

#	⊙				⋯	A	B	⊙ ↗	
	DN	size	mm	inch				MPa	psi
1Y42X-4-025	4	-025	4.0	5/32	1/4 - 28UNF-LH	87	50	300	43,500
1Y42X-6-025	4	-025	4.0	5/32	3/8 - 24UNF-LH	92	55	300	43,500
1Y42X-6-03	5	-03	4.8	3/16	3/8 - 24UNF-LH	108	58	400	58,000
1Y42X-9-03	5	-03	4.8	3/16	9/16 - 18UNF-LH	116	63	400	58,000
1Y42X-6-05	8	-05	7.9	5/16	3/8 - 24UNF-LH	116	63	320	46,400
1Y42X-9-05	8	-05	7.9	5/16	9/16 - 18UNF-LH	116	63	320	46,400
6Y4HX-16-8C	12	-08	12.7	1/2	1 - 12UNF-LH	147	77	200	29,000



## 1AY2X / 1AYJX – Type “M” female swivel

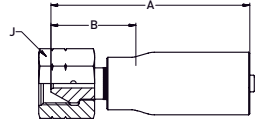

**MATERIAL** Nipple: very high strength stainless steel  
Shell and nut: high strength carbon steel, zinc plated

#	⊙				🌀	A	B	J	↻	
	DN	size	mm	inch					MPa	psi
1AY2X-6-025	4	-025	4.0	5/32	9/16 - 18UNF	61	24	22	300	43,500
1AY2X-6-03	5	-03	4.8	3/16	9/16 - 18UNF	91	38	22	400	58,000
1AY2X-8-05	8	-05	7.9	5/16	3/4 - 16UNF	91	38	27	320	46,400
1AY2X-10-05	8	-05	7.9	5/16	7/8 - 14UNF	91	38	30	320	46,400
1AY2X-13-05	8	-05	7.9	5/16	1 1/8 - 11UNF	91	38	36	320	46,400
1AYJX-11-08W	12	-08	12.7	1/2	1 - 12UNF	86	29	32	180	26,100
1AYJX-16-12W	20	-12	19.0	3/4	1 5/16-12UNF	90	31	41	140	20,300

Ultra-high pressure

## 16Y2X – High pressure female swivel

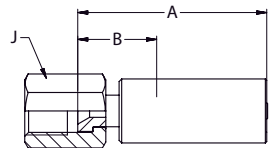

**MATERIAL** Nipple: very high strength stainless steel  
Shell and nut: high strength carbon steel, zinc plated

#	⊙				🌀	A	B	J	↻	
	DN	size	mm	inch					MPa	psi
16Y2X-4-025	4	-25	4	5/32	9/16 - 18	76	23	19	300	43,500
16Y2X-4-03	5	-03	4.8	3/16	9/16 - 18	76	23	19	280	40,600



## 692HX – BSP female swivel (60° cone)

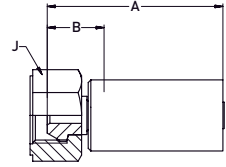

**MATERIAL** Nipple: very high strength stainless steel  
 Shell and nut: high strength carbon steel, zinc plated

#	⊙				⌚	A	B	J	⊙ ↗	
	DN	size	mm	inch	inch	mm	mm	mm	MPa	psi
692HX-4-3C	5	-03	4.8	3/16	1/4 BSPP	78	33	22	280	40,600

Ultra-high pressure



## 2741D – Ultra-high pressure water jetting hose



### APPLICATIONS

- For very-high pressure lances with working pressures up to 300 MPa for the construction and shipbuilding industries or for common industrial cleaning applications.
- Mainly used for hydrodemolition and removal of accumulated dirt and materials from surfaces such as concrete, asphalt and tanks.

### CONSTRUCTION

**Core tube** : Polyoxymethylene







**Pressure reinforcement** : Six spiral layers of maximum tensile steel wire

**Cover** : 1<sup>st</sup>: Polyamide; 2<sup>nd</sup>: Polyurethane, abrasion resistant

**Colour** : 1<sup>st</sup>: Red; 2<sup>nd</sup>: Black

### TEMPERATURE RANGE

-10°C up to +70°C

#													
	DN	size	mm	inch	mm	MPa	psi	MPa	psi	mm	kg/m		
2741D-05V34/10	8	-05	7.7	5/16	21.2	250	36,250	625	90,625	200	0.95		



NOTES -

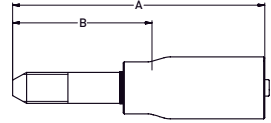

## 1YM2X – High pressure tube nipple metric – LH thread





**MATERIAL** Nipple: very high strength stainless steel  
 Shell and nut: high strength carbon steel, zinc plated

#						A	B		
	DN	size	mm	inch		mm	mm	MPa	psi
1YM2X-6-05	8	-05	7.9	5/16	M14x1.5-LH	116	63	320	46,400

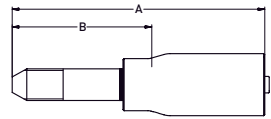
## 1Y42X – High pressure tube nipple UNF – LH thread



**MATERIAL** Nipple: very high strength stainless steel  
 Shell and nut: high strength carbon steel, zinc plated

#						A	B		
	DN	size	mm	inch		mm	mm	MPa	psi
1Y42X-6-05	8	-05	7.9	5/16	3/8 - 24UNF-LH	116	63	320	46,400
1Y42X-9-05	8	-05	7.9	5/16	9/16 - 18UNF-LH	116	63	320	46,400



## 1AY2X – Type “M” female swivel

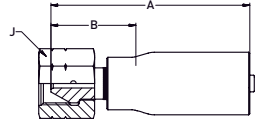

**MATERIAL** Nipple: very high strength stainless steel  
Shell and nut: high strength carbon steel, zinc plated

#	⊙				⋈	A	B	J	↗	
	DN	size	mm	inch					MPa	psi
1AY2X-8-05	8	-05	7.9	5/16	3/4 - 16UNF	91	38	27	320	46,400
1AY2X-10-05	8	-05	7.9	5/16	7/8 - 14UNF	91	38	30	320	46,400
1AY2X-13-05	8	-05	7.9	5/16	1 1/8 - 11UNF	91	38	36	320	46,400



## 2748D – Ultra-high pressure water jetting hose



### APPLICATIONS

- For very-high pressure lances with working pressures up to 300 MPa for the construction and shipbuilding industries or for common industrial cleaning applications.
- Mainly used for hydrodemolition and removal of accumulated dirt and materials from surfaces such as concrete, asphalt and tanks.

### CONSTRUCTION

**Core tube** : Polyoxymethylene  
**Pressure reinforcement** : Six spiral layers of maximum tensile steel wire

**Cover** : Polyamide  
**Colour** : Yellow, red

### TEMPERATURE RANGE

-10°C up to +70°C

#	Ø				Ø		↗		✂		↶	I
	DN	size	mm	inch	mm	MPa	psi	MPa	psi	mm	kg/m	
2748D-05V34	8	-05	7.8	5/16	17.3	280	40,600	700	101,500	230	0.9	

NOTES -

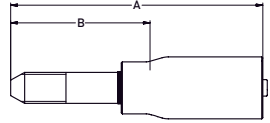

**1YM2X – High pressure tube nipple  
metric – LH thread**

**MATERIAL** Nipple: very high strength stainless steel  
Shell and nut: high strength carbon steel, zinc plated

#						A	B		
	DN	size	mm	inch				mm	mm
1YM2X-6-05	8	-05	7.9	5/16	M14x1.5-LH	116	63	320	46,400

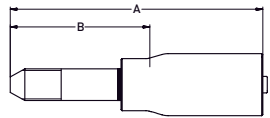
**1Y42X – High pressure tube nipple  
UNF – LH thread**

**MATERIAL** Nipple: very high strength stainless steel  
Shell and nut: high strength carbon steel, zinc plated

#						A	B		
	DN	size	mm	inch				mm	mm
1Y42X-6-05	8	-05	7.9	5/16	3/8 - 24UNF-LH	116	63	320	46,400
1Y42X-9-05	8	-05	7.9	5/16	9/16 - 18UNF-LH	116	63	320	46,400



## 1AY2X – Type “M” female swivel

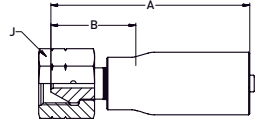

**MATERIAL** Nipple: very high strength stainless steel

Shell and nut: high strength carbon steel, zinc plated

#	⊙				⋈	A	B	J	⊙ ↗	
	DN	size	mm	inch		mm	mm	mm	MPa	psi
1AY2X-8-05	8	-05	7.9	5/16	3/4 - 16UNF	91	38	27	320	46,400
1AY2X-10-05	8	-05	7.9	5/16	7/8 - 14UNF	91	38	30	320	46,400
1AY2X-13-05	8	-05	7.9	5/16	1 1/8 - 11UNF	91	38	36	320	46,400

Ultra-high pressure

